



Magnetic actuator

21FR1-B

- Magnet Actuator
- Compatible with 20FR...6B Series

Dimensions

21FR

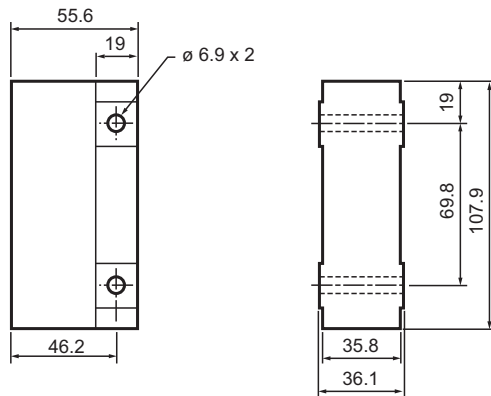

Mounting bracket (included)

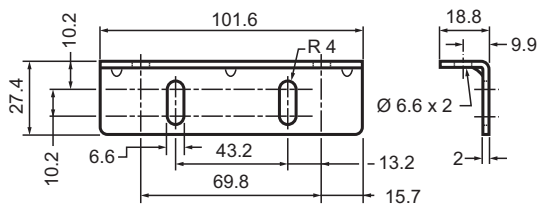

Technical Data

Nominal ratings

Switching state indicator	NO contact
---------------------------	------------

Ambient conditions

Ambient temperature	-25 ... 85 °C (-13 ... 185 °F)
---------------------	--------------------------------

Mechanical specifications

Housing material	aluminum
Sensing face	aluminum

Temperature Effects

Temperature must be taken into consideration when using magnetically operated switches. The sensing ranges given on the following pages are for head-on operations at room temperature (75° F). Sub-zero temperatures can cause permanently reduced sensitivity. Use the following table as a guide for potential sensitivity loss.

Model	Maximum possible sensitivity loss
20FR1-6B	2.03 mm
20FR3-6B	1.52 mm

Release date: 2020-03-31 Date of issue: 2020-09-03 Filename: 450016_eng.pdf